

136 Pers.

Anlieferung

Leinwand

Auf-
zug

Ausschank

Küche

Garderobe

EINGANG

EG.D1

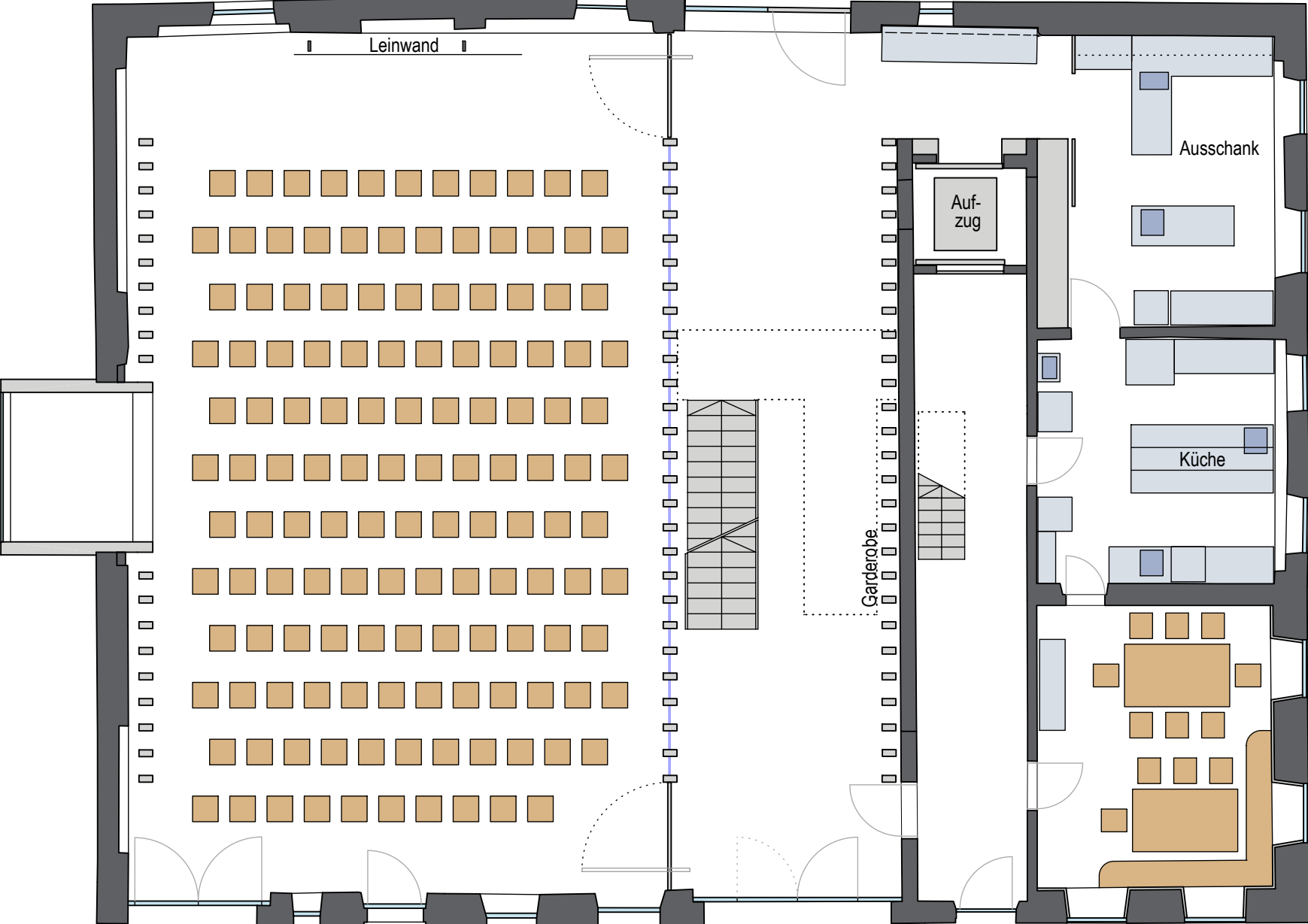

38 + 5 = 43 Pers.

Anlieferung



EINGANG

EG.D2

112 Pers.

Anlieferung

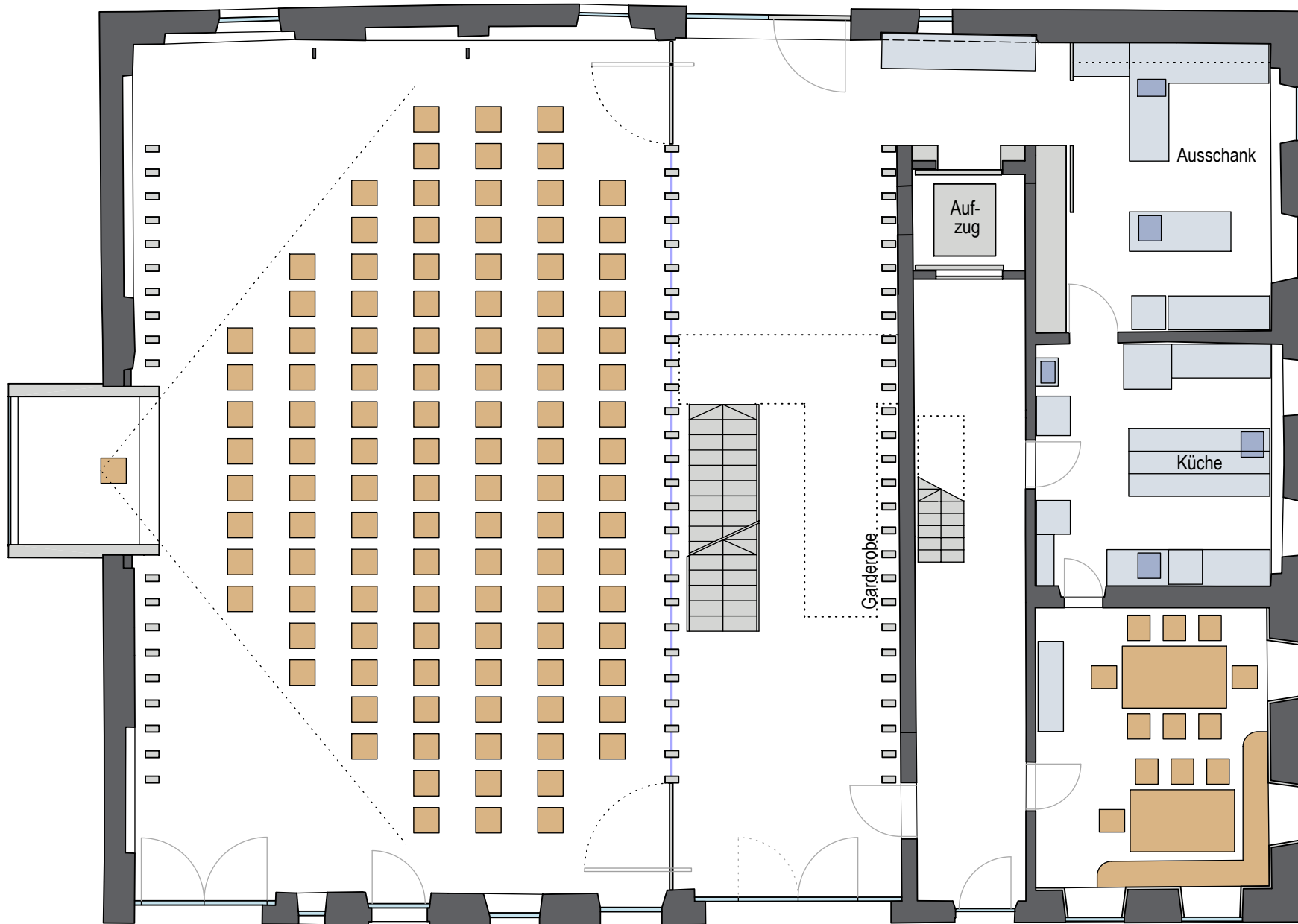

EINGANG

EG.E1

50 + 10 = 60 Pers. 25+5 = 30 Tische

Anlieferung



EINGANG

EG.F1